

BRAND Insert 2in1 for Cell Culture Plate 셀 컬처 플레이트용 인서트

- 2D & 3D Cell Culture 용
- Hanging 또는 Standing Position 기능을 선택 사용 가능 (2 in 1)
- 6-, 12- & 24-well Plate 또는 Culture Dish 와 같이 사용
- Uniform and Controlled Cell Growth
- CellGrade™ plus surface of Membrane
: Optimal Cell Attachment & Growth
- Sterile according to ISO 11137, Level SAL 10⁻⁶
- Non-cytotoxic according to ISO 10993-5
- Free of Pyrogen & Endotoxins, LAL test(< 0.01 EU/ml)
- Brand GmbH

Hanging

If you use the Insert 2in1 as a hanging insert, first add the medium to the multiwell plates and hang the insert inside the wells (make sure the medium comes into contact with the membrane). Then fill the insert with medium.

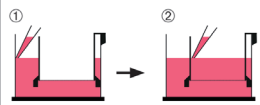

Standing

If you would like to use the Insert 2in1 as a standing insert, place the insert into the provided multiwell plate or culture dish. Add the medium to the insert and then into the well or the culture dish.

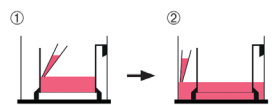

A closer look

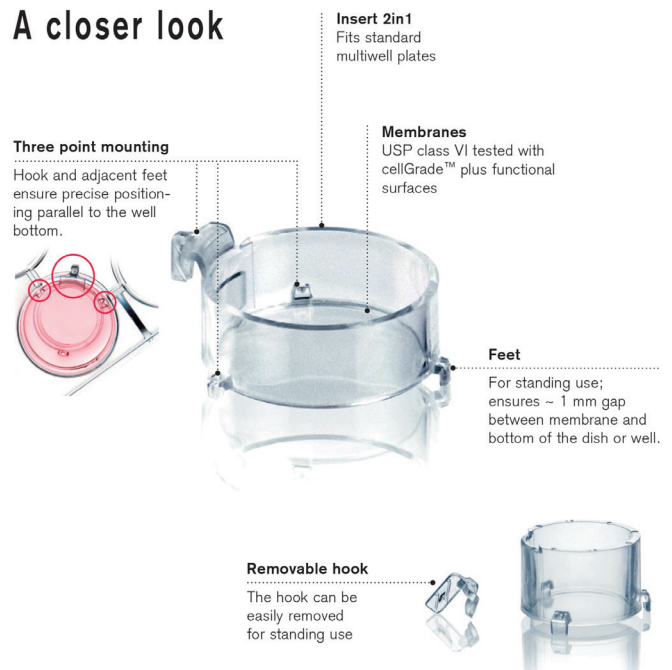

with PC Membrane

| Cat. No. | Model | Well | Pore Size | Diameter | Blister 포장 | PK Price ₩ |
|------------|--------|---------|-----------|----------|---------------------|--------------|
| P04-59-701 | 782700 | 24-well | 0.4 um | ø8.8 mm | Single (개별) | 48ea 585,300 |
| P04-59-703 | 782701 | | | | Multi-pack (4 x 12) | 48ea 528,800 |
| P04-59-705 | 782706 | | 8.0 um | | Single (개별) | 48ea 585,300 |
| P04-59-707 | 782707 | | | | Multi-pack (4 x 12) | 48ea 528,800 |
| P04-59-709 | 782720 | 12-well | 0.4 um | ø13.3 mm | Single (개별) | 48ea 650,200 |
| P04-59-711 | 782721 | | | | Multi-pack (4 x 9) | 36ea 439,800 |
| P04-59-713 | 782726 | | 8.0 um | | Single (개별) | 48ea 650,200 |
| P04-59-715 | 782727 | | | | Multi-pack (4 x 9) | 36ea 439,800 |
| P04-59-717 | 782740 | 6-well | 0.4 um | ø24.8 mm | Single (개별) | 24ea 416,700 |
| P04-59-719 | 782741 | | | | Multi-pack (4 x 6) | 24ea 386,400 |
| P04-59-721 | 782746 | | 8.0 um | | Single (개별) | 24ea 416,700 |
| P04-59-723 | 782747 | | | | Multi-pack (4 x 6) | 24ea 386,400 |

- Highly Transparent Membrane (PET) : Detailed Observation of Cell Culture under an Optical Microscope

with PET Membrane

| Cat. No. | Model | Well | Pore Size | Diameter | Blister 포장 | PK Price ₩ |
|------------|--------|---------|-----------|----------|---------------------|--------------|
| P04-59-731 | 782710 | 24-well | 0.4 um | ø8.8 mm | Single (개별) | 48ea 585,300 |
| P04-59-733 | 782711 | | | | Multi-pack (4 x 12) | 48ea 528,800 |
| P04-59-735 | 782716 | | 8.0 um | | Single (개별) | 48ea 585,300 |
| P04-59-737 | 782717 | | | | Multi-pack (4 x 12) | 48ea 528,800 |
| P04-59-739 | 782730 | 12-well | 0.4 um | ø13.3 mm | Single (개별) | 48ea 650,200 |
| P04-59-741 | 782731 | | | | Multi-pack (4 x 9) | 36ea 439,800 |
| P04-59-743 | 782736 | | 8.0 um | | Single (개별) | 48ea 650,200 |
| P04-59-745 | 782737 | | | | Multi-pack (4 x 9) | 36ea 439,800 |
| P04-59-747 | 782750 | 6-well | 0.4 um | ø24.8 mm | Single (개별) | 24ea 416,700 |
| P04-59-749 | 782751 | | | | Multi-pack (4 x 6) | 24ea 386,400 |
| P04-59-751 | 782756 | | 8.0 um | | Single (개별) | 24ea 416,700 |
| P04-59-753 | 782757 | | | | Multi-pack (4 x 6) | 24ea 386,400 |

- With High Pore Density Membrane (PC) : High Permeability

BRAND Insert 2in1 Track-etched Membrane 종류 및 특성

| Type | PET membrane | | PC membrane | |
|--------------|---|-------------------------------------|--|-------------------------------------|
| Pore Size | 0.4 um | 8 um | 0.4 um | 8 um |
| Pore Density | 2 x 10 ⁶ cm ² | 2 x 10 ⁵ cm ² | 1 x 10 ⁸ cm ² | 1 x 10 ⁵ cm ² |
| Optic | 반투명(Translucent) | 반투명(Translucent) | 투명(Transparent) | 반투명(Translucent) |
| Property | Extremely thin and stable membrane with defined pore sizes and pore density, which can easily be further processed after separation from the insert housing. Compatible with the most common fixation and staining protocol | | Ultra-thin membrane with low autofluorescence, also usable without additional layer, provides optimal support for proliferation and differentiation. Compatible with the most common fixation and staining protocols | |

Co-culture

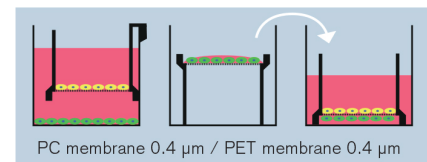

Transmigration, chemotaxis

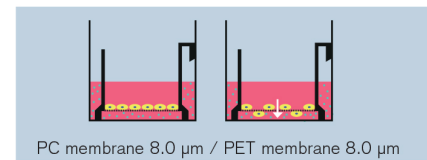

Air-lift culture in multiwell plate

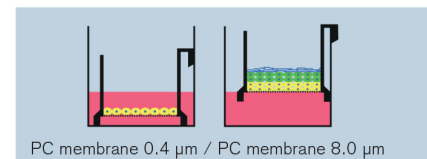

Transport/barrier analysis (TEER measurement), cytotoxicity

